

Sandwich panels insulated with glued expanded polystyrene, with steel sheet perimeter frame. URAN W05 EPS system panels have an excellent aesthetic finishing at a competitive price.

### Certifications

**CE** CE marking  
in accordance with EN 14509

### Use and specifications



Laboratories



Reduced weight



Fast assembly



Upon request, internal fitting for technical equipment

Technical drawing

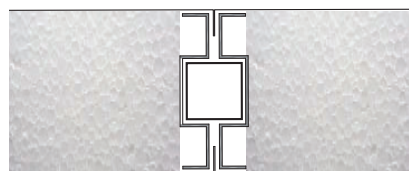
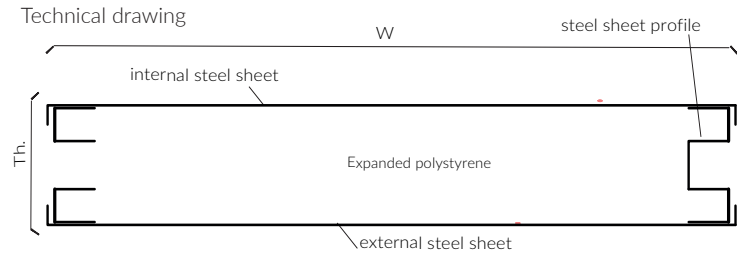

F/F aluminum

### Reference measurements\*:

Width.	Length.	Thickness.
1200 mm	max 4000 mm	from 50 mm to 80 mm

\* Size can be customized to prevent cuts and adjustments.

name	panel thickness (mm)	nominal sheet thickness		insulated core	panel weight (Kg/m <sup>2</sup> )	transmitt. (W/m <sup>2</sup> K)
		external (mm)	internal (mm)			
W05L EPS	60	0.6	0.6	expanded polystyrene d. 20 kg/m <sup>3</sup>	12.50	0.536
W05L EPS	80	0.6	0.6	expanded polystyrene d. 20 kg/m <sup>3</sup>	13.10	0.409
W05L EPS	50	0.6	06	expanded polystyrene d. 20 kg/m <sup>3</sup>	12.20	0.634