

Structural insulated panel used as an external wall for the Panhouse construction system, with external cladding in magnesium oxide. PVC tubes are pre-set internally for technical equipment (water, electricity and gas). Can be painted like traditional masonry or finished with the installation of ceramic tiles and wall cabinets.

Certifications

CE CE marking
in accordance with EN 14509

30 REI Fire resistance
30 minutes REI in
accordance with EN 1361-1

Use and specifications

Housing solutions

Thermal insulation

Quick assembly

Technical drawing

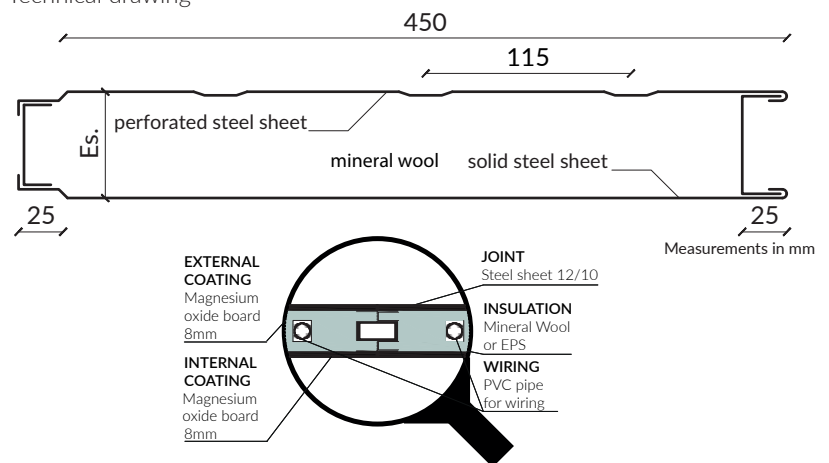

Reference measurements*:

Width.	Length.	Thickness.
1060-1200 mm	max 3600 mm	50-100 mm

* Size can be customised to prevent cuts and adjustments.

INSUL.	THICKNESS (mm)	U (W/m ² K)	WEIGHT (kg/m ²)
EPS	80	0.60	25.3
EPS	100	0.45	26.3
EPS	120	0.36	27.3
LR	80	0.64	28.3
LR	100	0.48	30.7
LR	120	0.39	33.2